



TAI-SAW TECHNOLOGY CO., LTD.

No. 3, Industrial 2nd Rd., Ping-Chen Industrial District,
Taoyuan, 324, Taiwan, R.O.C.

TEL: 886-3-4690038 FAX: 886-3-4697532

E-mail: tstsales@mail.taisaw.com Web: www.taisaw.com

Approval Sheet For Product Specification

Issued Date:

Product Name: SAW Filter 821MHz SMD 3.0×3.0mm

TST Parts No.:TA0330A

Customer Parts No.:_____

Company: _____
Division: _____
Approved by : _____
Date: _____

Checked by: _____ Elvis Chiu

Approval by: _____ Francis Chen

Date: _____ 2004/02/24



TAI-SAW TECHNOLOGY CO., LTD.

No. 3, Industrial 2nd Rd., Ping-Chen Industrial District,
Taoyuan, 324, Taiwan, R.O.C.

TEL: 886-3-4690038 FAX: 886-3-4697532

E-mail: tstsales@mail.taisaw.com Web: www.taisaw.com

SAW Filter 821 MHz

MODEL NO.: TA0330A

REV. NO.:1

A. MAXIMUM RATING:

1. Input Power Level: 10 dB_m
2. DC voltage: 3 V
3. Operating Temperature: -25°C to +75°C
4. Storage Temperature: -40°C to +85°C

RoHS Compliant
 Lead free
 Lead-free soldering

B. ELECTRICAL CHARACTERISTICS:

Item		Unit	Specification		
			Min.	Typ.	Max.
Center Frequency	F _c	MHz	-	821	-
Insertion Loss	816~826 MHz	dB	-	1.9	3.5
Ripple	816~826 MHz	dB	-	0.2	2.0
VSWR	816~826 MHz		-	1.3	2.0
Absolute Attenuation					
861 ~ 871	MHz	dB	20	37	-
Source impedance	Z _s	Ω	-	50	-
Load impedance	Z _L	Ω	-	50	-

Note1. No matching network required for operation at 50 Ω

C. Frequency Characteristics :

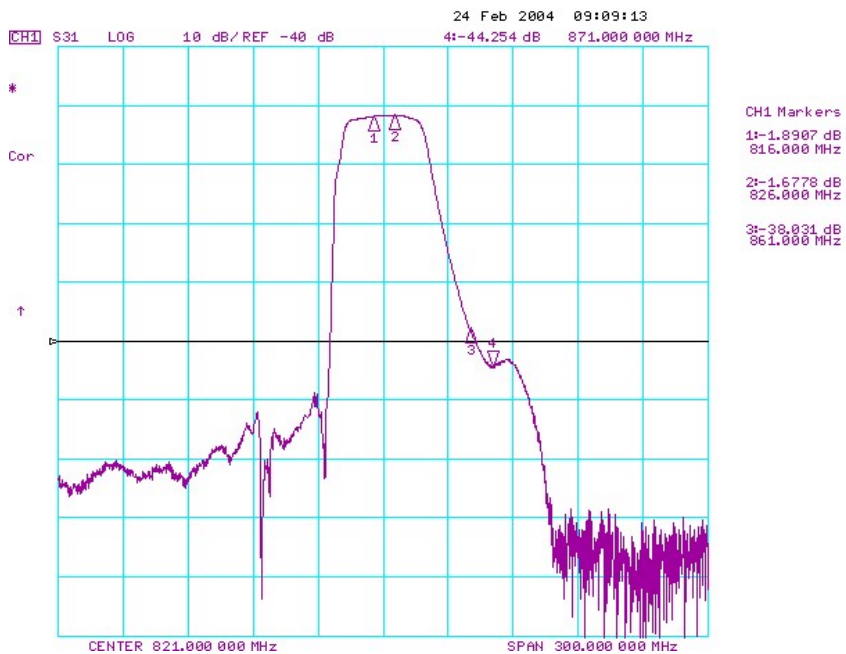
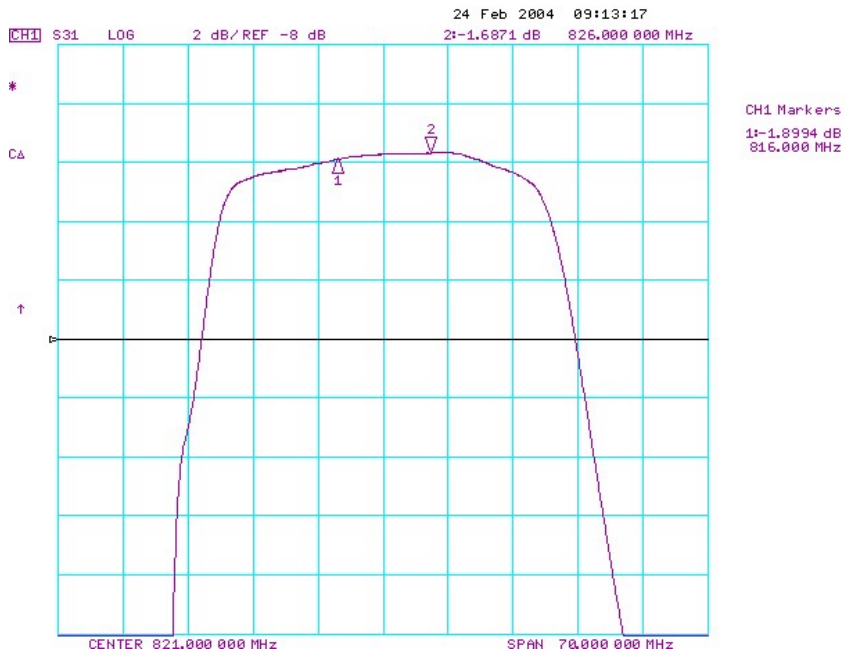

D.Reflections Functions :

S11:

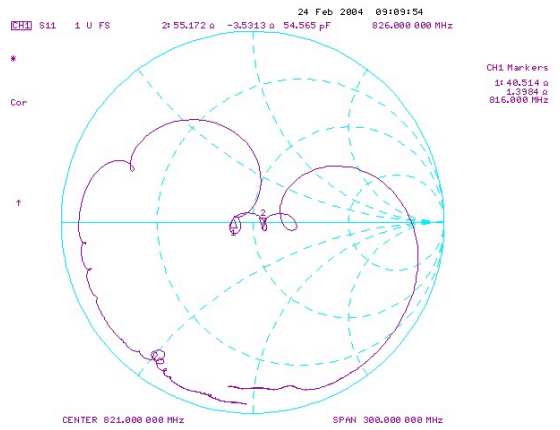

S22:

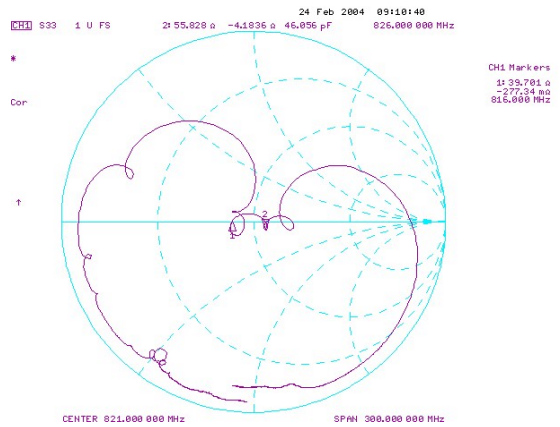
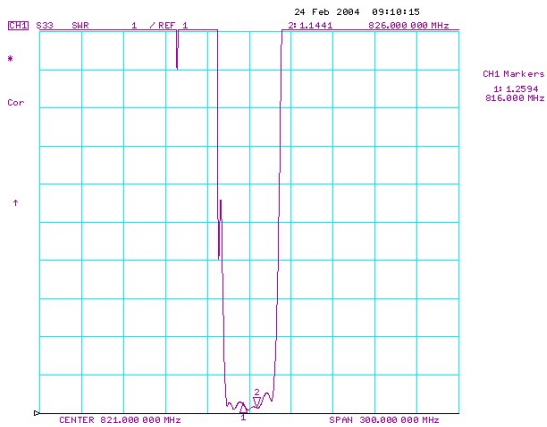

E. MEASUREMENT CIRCUIT:

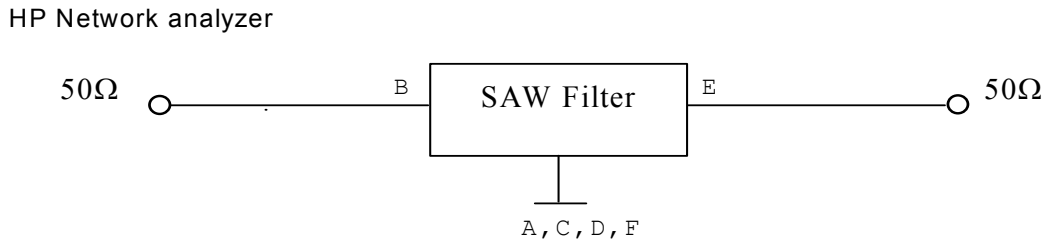

F. OUTLINE DRAWING:

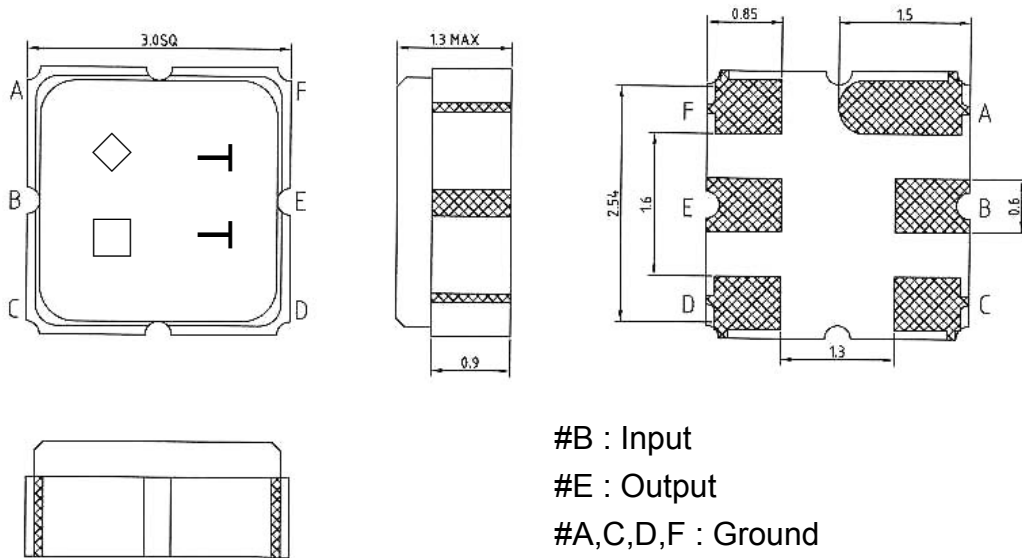

#B : Input
 #E : Output
 #A,C,D,F : Ground
 ◇ : Year Code
 □ : Date Code
 Unit: mm

G. PACKING:

1. REEL DIMENSION

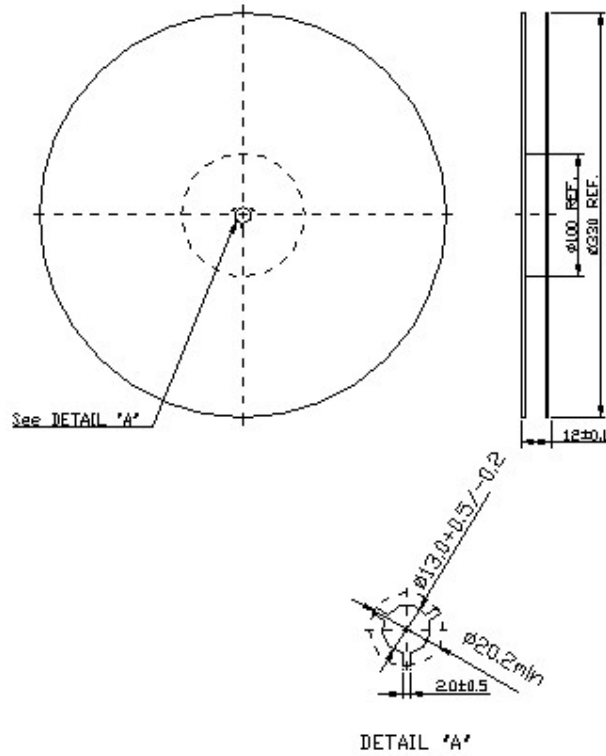

2. TAPE DIMENSION

